

Place Directorate

Assistant Director for Highways and Parking Services: Anthony Hall
Argall Avenue, Leyton, London E10 7AS



Date: 29 August 2024
Telephone: 0208 496 3000
Email: enjoy@walthamforest.gov.uk

Dear Resident / Business,

Hoe Street E17 - Overnight Road Resurfacing / Temporary Road Closure

The Hoe Street scheme between Orford Road and Lea Bridge Road aims to provide more transport options to local people travelling between Lea Bridge Road, Walthamstow Central, and the town centre, and build upon the existing network of safe and direct walking and cycling routes across the borough. Following the completion of statutory consultation in August 2023, we are now starting the next stage of construction.

We are resurfacing Hoe Street between Pendlestone Road and Lea Bridge Road from **9 September 2024 to 18 September 2024**. This is essential work which will be undertaken at night between the hours of **9pm and 5am**.

To allow the resurfacing to be carried out safely and efficiently, Hoe Street and the following side streets will be closed at night during this period: Pendlestone Road, Grove Road, Granville Road, Clarendon Road, Boundary Road, Bakers Avenue, Livingstone Road, Poplars Road and Sycamore Path. Please see the following diagram below:

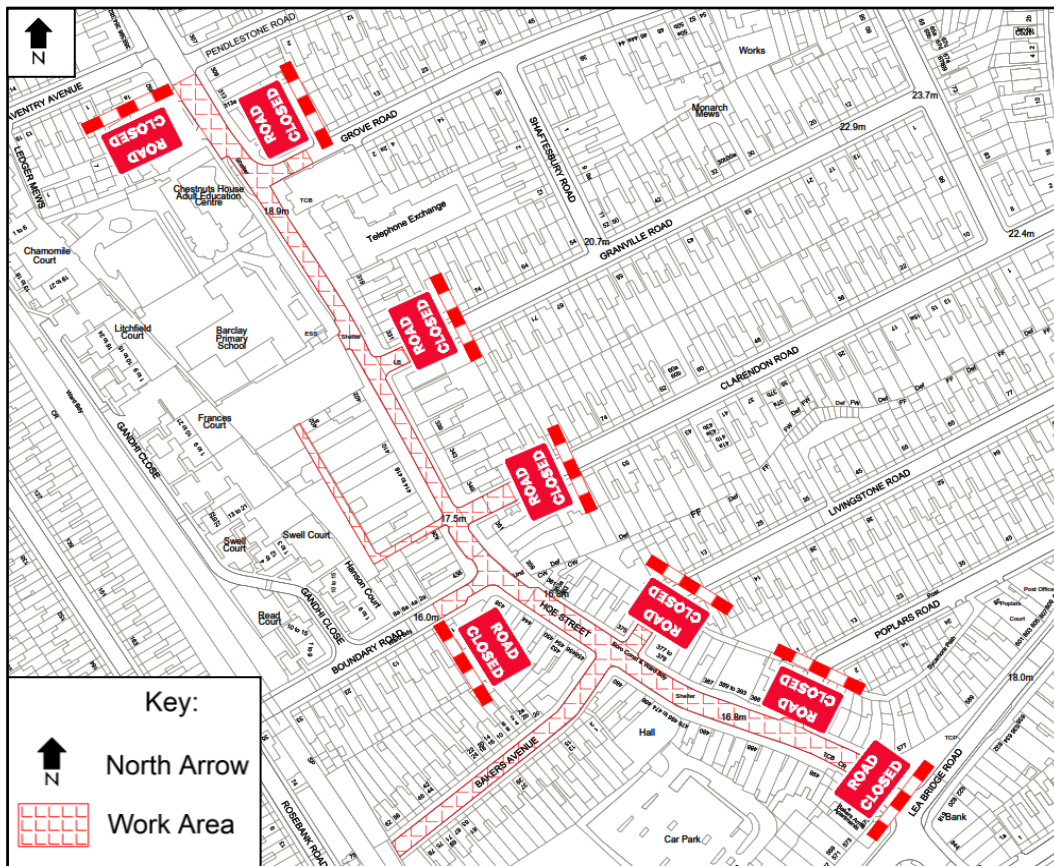

Residents are advised to plan for this temporary road closure. **During the resurfacing works, motor vehicles WILL NOT be able to access the work area, including to and from all adjacent side streets.** Vehicles found within the work area will be removed.

If you need to use your vehicle during these works, it is advised you make alternative parking arrangements. Permit parking schemes operate in some residential roads surrounding Hoe Street, but these do not operate overnight so you will be able to park outside the controlled hours shown on the parking signs on street, which in most streets are Monday to Saturday, 8am-6.30pm.

The emergency services have been informed of the arrangements and access for fire, police and ambulances will be maintained throughout the works.

Further information regarding this scheme can be accessed via the link below:

<https://www.walthamforest.gov.uk/parking-roads-and-travel/active-and-sustainable-transport-schemes/current-schemes/ho-e-street-between-orford-road-and-lea-bridge-road>

Thank you for your patience and understanding while we carry out these works to improve our streets. If you have any questions relating to the scheme, please contact us via the details shown below:

Email:

enjoy@walthamforest.gov.uk

Write to:

Enjoy Waltham Forest Team, Waltham Forest Council, Low Hall Argall Avenue, London, E10 7AS

Phone:

020 8496 3000 to speak to Waltham Forest Direct (Monday to Friday, 9am-5pm)

Best regards,

Enjoy Waltham Forest team

Parking & Penalty Charges Information

If you suspect your vehicle may have been removed, you should contact TRACE on 0300 0770100 or text "trace" followed by your vehicle registration to 66663, who should be able to confirm if your vehicle has been relocated or removed to a pound.

Penalty notice - £130.00 (discounted to £65.00 if paid within 14 days of issue). Details of payment will be on the back of the ticket.

Removal of vehicles and impounded – a charge of £65.00 for the Penalty Notice and £200.00 for the release of the vehicle to be paid within the first 24 hours, after every 24-hour period, a storage charge of £40.00 will be added. Collection of impounded vehicles and payments for the release of a vehicle are to be made at the following address:

Council Car Pound

North London Pound
Unit 1, Waltham Park Way
London
E17 5DU

Phone: 0203 092 0112 and select option 1 at all times.

Opening Hours

The pound is open:

- Monday to Saturday, 7am to 10pm; Sunday, 8am to 8pm